

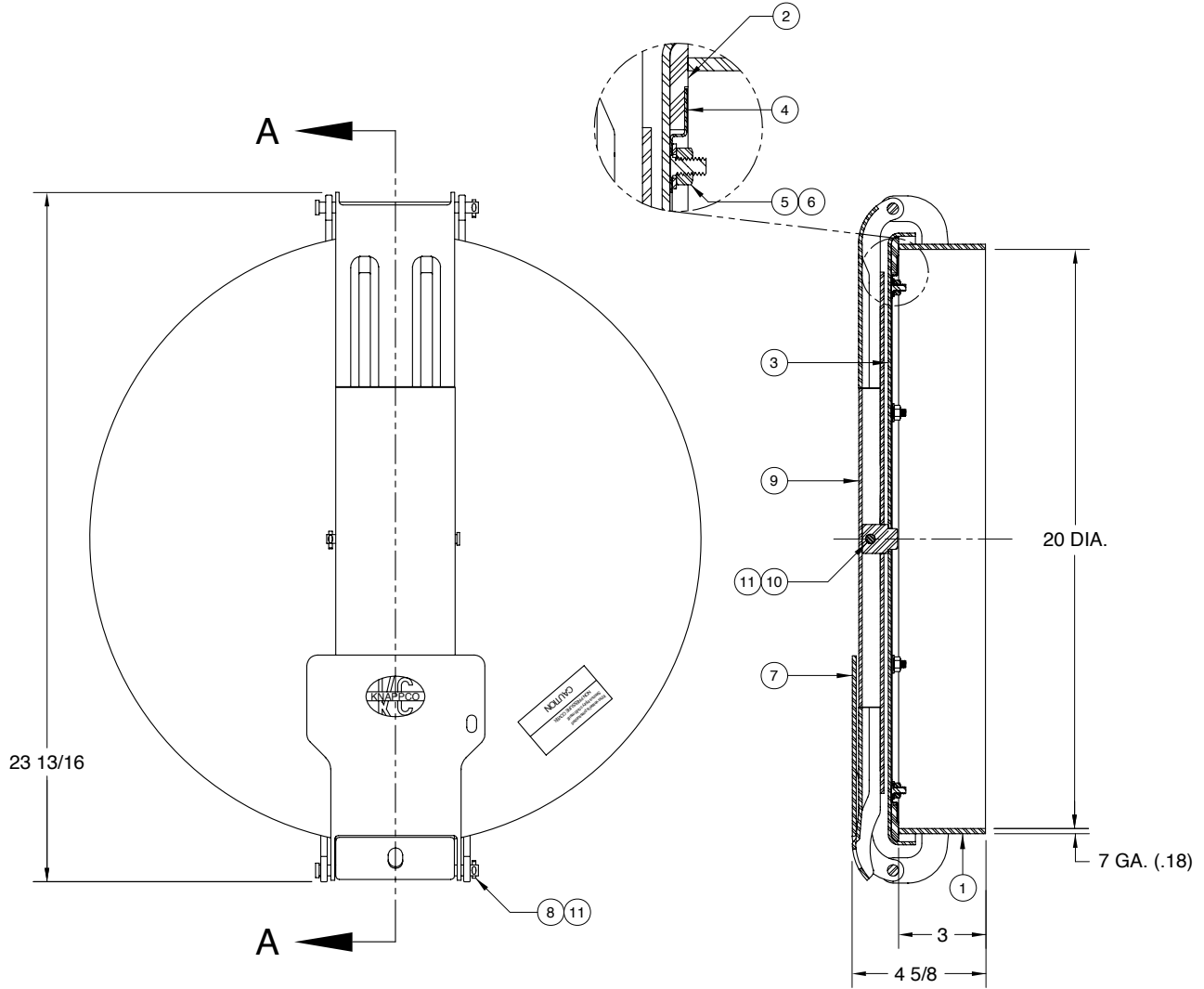

AN **OPW** FLUID TRANSFER GROUP COMPANY

LE3310 20" Manhole Assembly



SECTION A-A

ITEM	PART NUMBER	DESCRIPTION	QTY.
1	3554	WELD RING ASSY (S.S.)	1
2	1026	GASKET (BUNA)	1
3	2917	COVER WELDMENT (S.S.)	1
4	2477	GASKET RETAINER (S.S.)	1
5	1088	HEX NUT (S.S.)	6
6	1330	WASHER (S.S.)	6
7	1127	LATCH (S.S.)	1
8	2090	CLEVIS PIN (S.S.)	2
9	2915	STRONGBACK ASSY. (S.S.)	1

ITEM	PART NUMBER	DESCRIPTION	QTY.
10	2920	CLEVIS PIN (S.S.)	1
11	1083	COTTER PIN (S.S.)	3

ALTERNATE SEALING MEDIA

PART NUMBER	DESCRIPTION
1432	GASKET (WHITE NEOPRENE)
2726	GASKET (HIGH TEMP.)
3622	GASKET (EPDM)
2551 / 1026	GASKET (TEFLON ENVELOPE)
2573	GASKET (VITON)



PHONE: (816) 741-6600 • (888) 526-5657 • Fax: (816) 741-1061
 4304 Mattox Road • Kansas City, MO 64150 • www.knapcco.com