

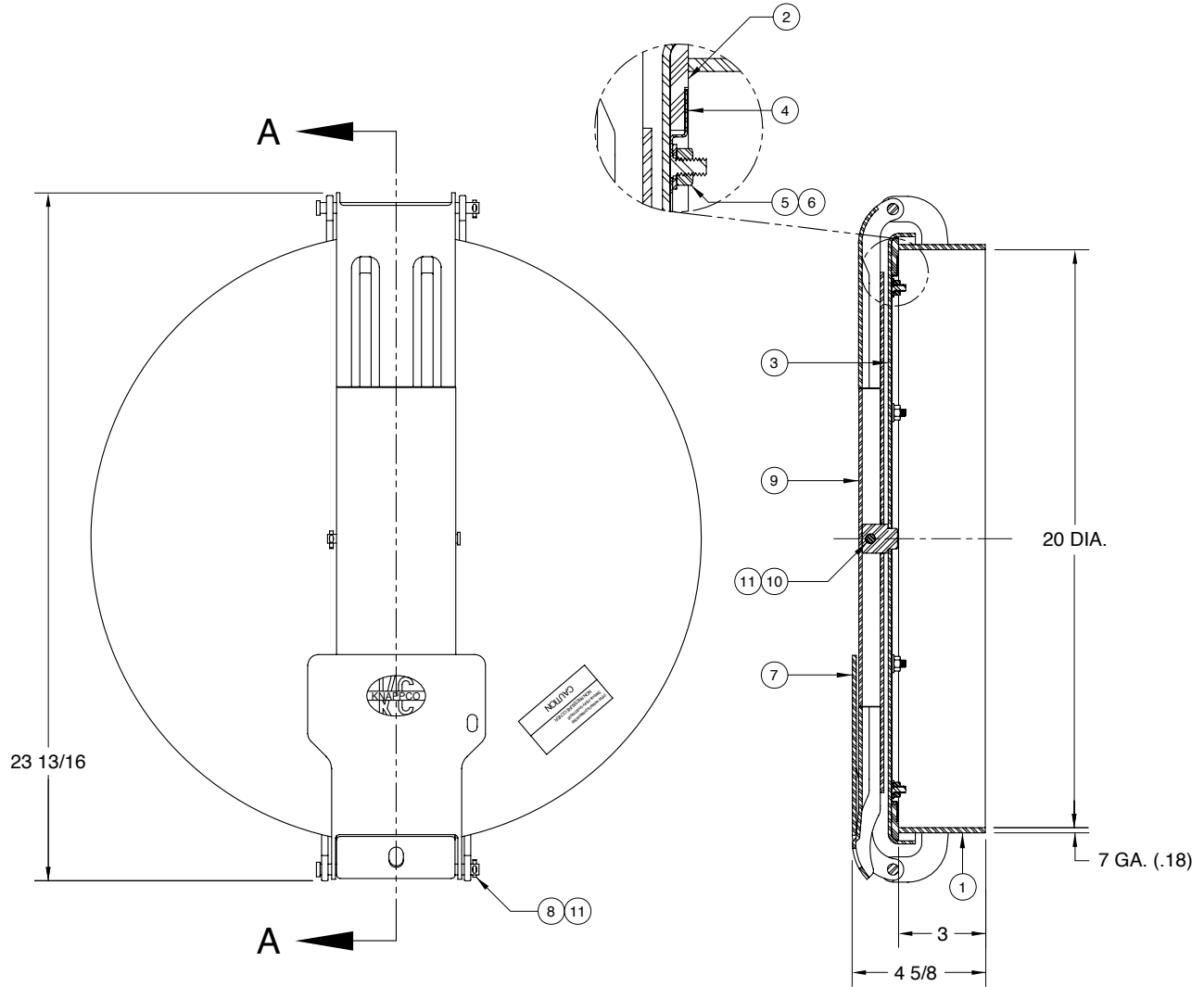

AN OPW® FLUID TRANSFER GROUP COMPANY

# LE1110 20" Manhole Assembly



SECTION A-A

ITEM	PART NUMBER	DESCRIPTION	QTY.
1	3537	WELD RING ASSY (STEEL)	1
2	1026	GASKET (BUNA)	1
3	2364	COVER WELDMENT (STEEL)	1
4	1027	GASKET RETAINER (STEEL)	1
5	1059	HEX NUT (PLATED)	6
6	1036	WASHER (PLATED)	6
7	1125	LATCH (STEEL)	1
8	2106	CLEVIS PIN (PLATED)	2
9	2365	STRONGBACK ASSY. (STEEL)	1

ITEM	PART NUMBER	DESCRIPTION	QTY.
10	2658	CLEVIS PIN (PLATED)	1
11	1045	COTTER PIN (PLATED)	3

ALTERNATE SEALING MEDIA

PART NUMBER	DESCRIPTION
1432	GASKET (WHITE NEOPRENE)
2726	GASKET (HIGH TEMP.)
3622	GASKET (EPDM)
2551 / 1026	GASKET (TEFLON ENVELOPE)
2573	GASKET (VITON)



PHONE: (816) 741-6600 • (888) 526-5657 • Fax: (816) 741-1061  
 4304 Mattox Road • Kansas City, MO 64150 • [www.knappco.com](http://www.knappco.com)